

CONSTRUCTION NOTES

Obtain Construction Plans from Designer prior to starting job.

Coordinate with Contractor / Engineering Firm for exact locations of proposed structures and facilities prior to installation of gas facilities.

Install new main as shown or as directed in field at time of installation.

Long side mains and services to be installed below proposed sub-cuts (See Construction Plans).

All test points should be installed in the boulevard or other acceptable locations and avoid placement in driving lanes.

NOTE: BORE ALL PAVED STREETS AND DRIVEWAYS
Minimum depth requirements for crossings of state highways and county roads is 60". **Minimum depth requirements for crossings of city streets and township roads is 48".**
Minimum depth for parallel installations on state highways and county roads is 36". **Minimum depth for parallel installations on city streets and township roads is 30".**

Project area not cleared for internal contaminants. Due to pipe size in project area no internal testing method is allowed. See packet for special abandon/removal requirements. Any pipe that may need removal must be disposed of by CenterPoint Energy.

CONSTRUCTION PROCEDURES

Install; Clean and Test; and Put in Service; Proposed new main as shown.

Purge new main until essentially 100% reading is obtained on Combustible Gas Indicator. See CenterPoint Energy Construction and Service Manual Section CS-B-1.230 for purging mains into service.

Complete all Service / Meter Work as directed. (See Service Survey)

Cut and Abandon existing main as shown. Purge abandoned mains until essentially 0% gas reading is obtained on Combustible Gas Indicator. See CenterPoint Energy Construction and Service Manual Section CS-B-1.110 and Section CS-B-1.230 for purging mains out of service using air movers.

Install a marker ball at a new end of main, at a valve, at each ell of a horizontal offset, at road crossings and at any fitting or pressure control identified as needing to be located in the future. Refer to CenterPoint Energy Construction and Service Manual section CS-B-1.310 for installation procedures.



MINNESOTA REGION

PROPRIETARY AND CONFIDENTIAL

PROJECT #: **69197594**

M07300 WINSTED

ONE CALL:
 McLeod
 *NE10 T117/R27
 *NW11 T117/R27
 *SE3 T117/R27
 *SW2 T117/R27
 * = this Page

LEGEND:

- ACTIVE MAIN
- DESIGNED MAIN
- - - PROPOSED ABANDONED MAIN
- ⊙ ABANDONED MAIN

PIPE REQUIRED:
 227' 2" TR CL-5

 227' PIPE

PROPOSED ABANDONED PIPE:
 214' 2" TR CL-5

 214' PIPE

COPIES:
 PIPELINE INTEGRITY: N
 GAS VALVE: N
 DD NUMBER: NA
 CORROSION: NA
 EMP: N

FOLLOW INTERNAL PIPE SAMPLING REQUIREMENTS? Y
 SURVEYOR REQUIRED? N
 RETURN PACKET TO ENG? N

PERMITS: MCLEOD COUNTY

PROJECT DESCRIPTION: SREL
 MAIN AVE W

DESIGNER: Travis Denzel
 PHONE #: 612-321-5207
 DRAWN BY: Travis Denzel
 DESIGN DATE: 4/9/2014

REVISION INFO:

Main SCALE 1" : 100'
 SCAN DATE: SHEET 1 OF 1

04/24/2014 06:37:19 AM DESIGNER EXPRESS DESIGN

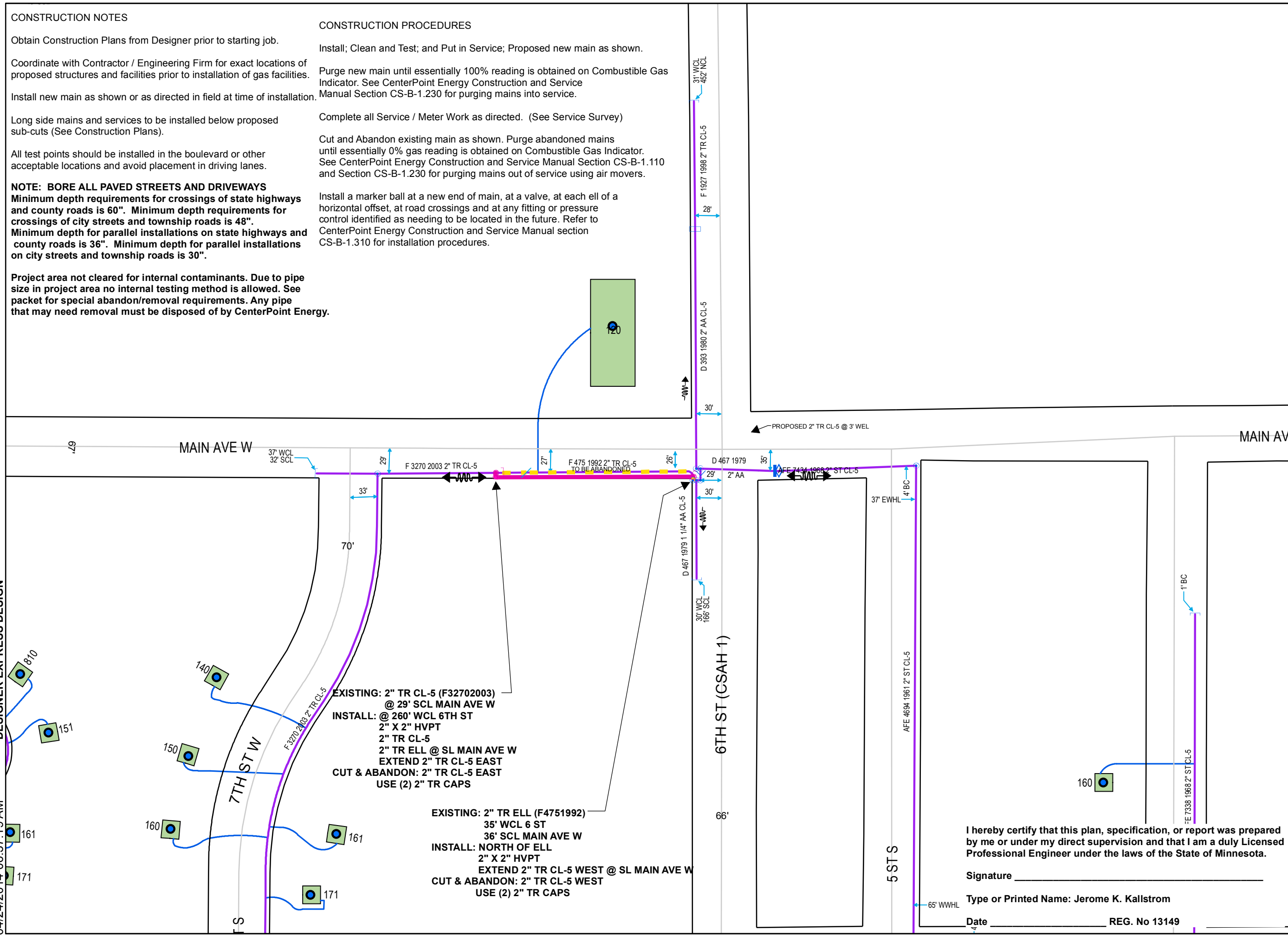

EXISTING: 2" TR CL-5 (F32702003)
 @ 29' SCL MAIN AVE W
INSTALL: @ 260' WCL 6TH ST
 2" X 2" HVPT
 2" TR CL-5
 2" TR ELL @ SL MAIN AVE W
 EXTEND 2" TR CL-5 EAST
CUT & ABANDON: 2" TR CL-5 EAST
 USE (2) 2" TR CAPS

EXISTING: 2" TR ELL (F4751992)
 35' WCL 6 ST
 36' SCL MAIN AVE W
INSTALL: NORTH OF ELL
 2" X 2" HVPT
 EXTEND 2" TR CL-5 WEST @ SL MAIN AVE W
CUT & ABANDON: 2" TR CL-5 WEST
 USE (2) 2" TR CAPS

I hereby certify that this plan, specification, or report was prepared by me or under my direct supervision and that I am a duly Licensed Professional Engineer under the laws of the State of Minnesota.

Signature _____
 Type or Printed Name: Jerome K. Kallstrom
 Date _____ REG. No 13149