

NEAREST CROSS STREET
HWY 7 JUST NORTH OF CSG

INTERSET 2-45' POLES. THE FIRST ONE JUST NORTH OF DRIVEWAY ENTRANCE (TO MAINTAIN CLEARANCE OVER THEIR DRIVEWAY) AND THE 2ND 25' NORTH OF IT. (THIS WILL BE THE 3PHS TERM POLE.) BUILD BOTH TANGENT. FUSE 65T AT TERM POLE. LABEL D56090F09

NOVEL MARTIN SOLAR ONE
19750 COUNTY ROAD 9
LESTER PRAIRIE, MN
TOBIAS BROWN
651-492-0462

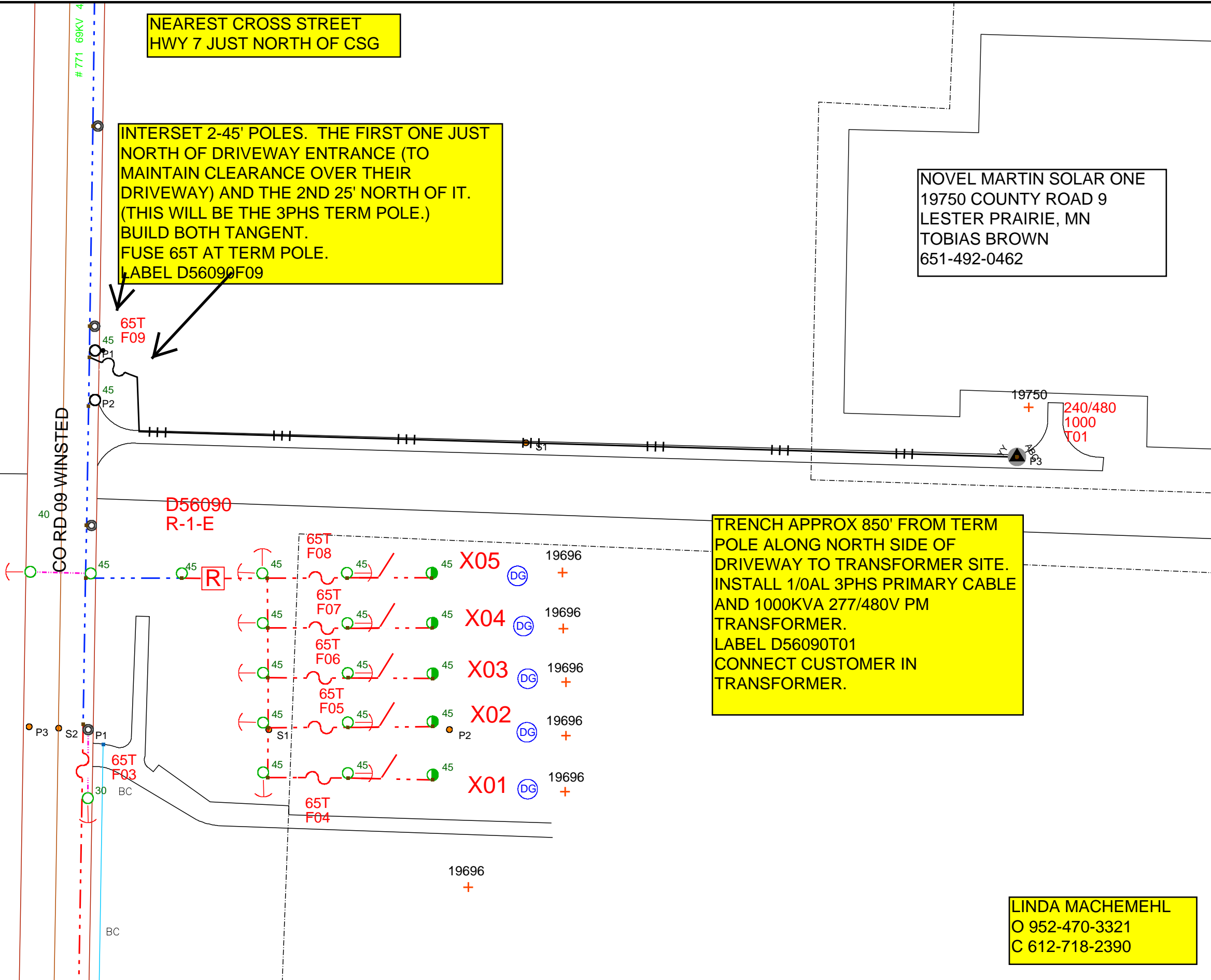

TRENCH APPROX 850' FROM TERM POLE ALONG NORTH SIDE OF DRIVEWAY TO TRANSFORMER SITE. INSTALL 1/0AL 3PHS PRIMARY CABLE AND 1000KVA 277/480V PM TRANSFORMER. LABEL D56090T01 CONNECT CUSTOMER IN TRANSFORMER.

LINDA MACHEMEHL
O 952-470-3321
C 612-718-2390

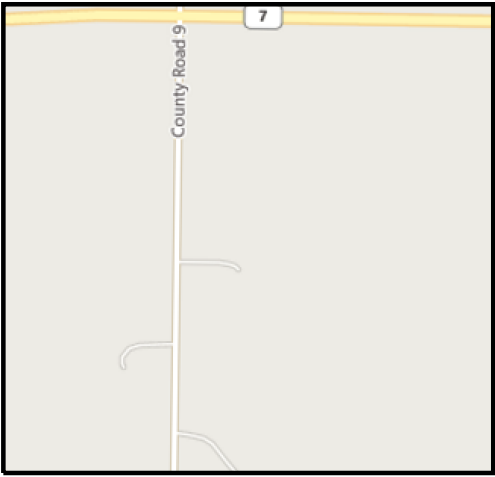

Work Order Information	
Service Request #	:
Design Number	: 000000782130
Designer/Planner ID	: mchl02
Designer/Planner Name	: Machehmel,Linda
Designer/Planner Ph #	: 952-470-3321
Manager Approval	:

Joint Utility	
E:	G:
T:	C:

Design Location	
Division	: MINNETONKA
County	: MC LEOD
City	: LESTER PRAIRIE
Address	: 19750 COUNTY ROAD 9
T: 117N	R: 27W S: 36
Map #	: D56090 Permit :

Electric	
Feeder:	LSP021 Voltage: 277/480V
Phase:	Bkup Dev ID:

Gas	
System	: 12.5KV Pressure :
Size	: Material :
Dead End	:

Work Order # :
Date: 01/03/2019
Sketch: 1 OF 1
Scale: 1" equals 100'

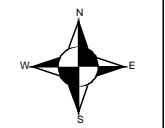

CONSTRUCTION USE ONLY
 NO CHANGES (BUILT AS DESIGNED)
 CHANGES MADE AS INDICATED (ALL URD MUST HAVE ACTUAL MEASUREMENTS FROM THE FIELD SITE)

RFO _____
FOREMAN _____ DATE _____
TEAM LEADER _____

DISCLAIMER: THERE ARE NO REPRESENTATIONS OR WARRANTIES (EXPRESS OR IMPLIED) ABOUT THE ACCURACY OF THIS PRINT. THIS PRINT IS PROVIDED WITH NO CLAIM AS TO PRINT COMPLETENESS, TIMELINESS, ACCURACY OF CONTENT OR USEFULNESS. STATE LAW REQUIRES ANYONE DIGGING, GRADING OR EXCAVATING TO OBTAIN A PRIOR FIELD LOCATE OF ALL UTILITIES; THIS PRINT DOES NOT DISCHARGE THIS REQUIREMENT OR ANY OTHER REQUIREMENT. THE COMPANY AND ITS AFFILIATES ASSUME NO LEGAL RESPONSIBILITY OR LIABILITY FOR THE RECIPIENT'S USE (OR ANY OTHER PARTIES' USE) OF THE PRINT, INCLUDING THE RECIPIENT'S INTENDED PURPOSE IN USING THE PRINT. NO COMPANY EMPLOYEE OR OTHER PARTY HAS BEEN AUTHORIZED TO PROVIDE THIS PRINT FOR PLANNING OR ESTIMATING PURPOSES; RELY ON THIS PRINT AT YOUR OWN RISK. BY ACCEPTING THIS PRINT, THE RECIPIENT & ANY OTHER PARTY RECEIVING A COPY OF THE PRINT ACKNOWLEDGES AND AGREES TO THIS DISCLAIMER. For All Field Locates Call 811